



NIBCO INC. World Headquarters ■ 1516 Middlebury St. ■ Elkhart, IN 46516-4714 U.S.A. ■ [www.nibco.com](http://www.nibco.com)

# 175 lb. wwp iron body check valve

Fire Protection Valve • UL/ULC Listed • FMRC Approved\* • UL listed at 175 psi sizes  
4", 6", 8", 10", 12"

Double-Door • Wafer Style • Rubber Seat • Spring Actuated

**200 PSI Non-Shock Cold Water General Service**

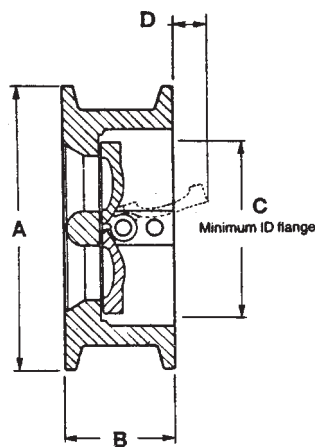

**KW-900-W**

## MATERIAL LIST

PART	SPECIFICATION
1. Body	Cast Iron ASTM A-126 Class B
2. Disc Plate	Bronze ASTM B-62
3. Seal	Buna-N (Integral with Body)
4. Pipe Plugs (4)	Cast Iron ASTM A-126 Class B
5. Stop Shaft	SS ASTM A-479
6. Spring	SS Spring Wire ASTM A-313
7. Disc Shaft	SS ASTM A-479
8. Washer	SS 18-8



**KW-900-W**  
wafer style

Nominal Size	Dimensions				Flow Rate G.P.M. *	Friction Loss, psi*	Approx. Net Wt.
	A	B	C	D			
2 1/2**	4 7/8	2 1/8	1 1/8	5/32	300	25	5.5
3**	5 3/8	2 1/4	2 1/2	5/8	450	6	7.5
4	6 7/8	3 3/8	N.A.	N.A.	750	4.5	15
5**	7 3/4	2 3/4	4 1/2	1 11/32	1000	3	17.5
6	8 3/4	4 1/8	4 1/8	19/32	1500	3.5	33
8	11	4 3/4	6 5/8	1 1/2	3000	4	58
10	13 3/8	6	8 1/4	1 5/8	5000	4.5	89
12	16 1/8	7 3/8	9 7/8	2	7000	3.5	160

\* FM Approval is for use as anti-water hammer check valve. 200 psi non-shock cold water approval rating. Flow rates/friction loss are maximum anticipated per size per FM Approval Guide.

\*\* These sizes FM Approved only, not UL listed.

NOTE: 14" and 16" sizes also available, 150 psi wwp, FM approved only - P.O.A.

## FEATURES

- Spring loaded for fast closure, eliminating reverse flow slam and water hammer.
- Easily installed, with gasket, between standard class 125 flanges.
- Only one set of flange studs is needed.
- May be installed in both horizontal and vertical lines with upward flow.



4" - 12" only

