

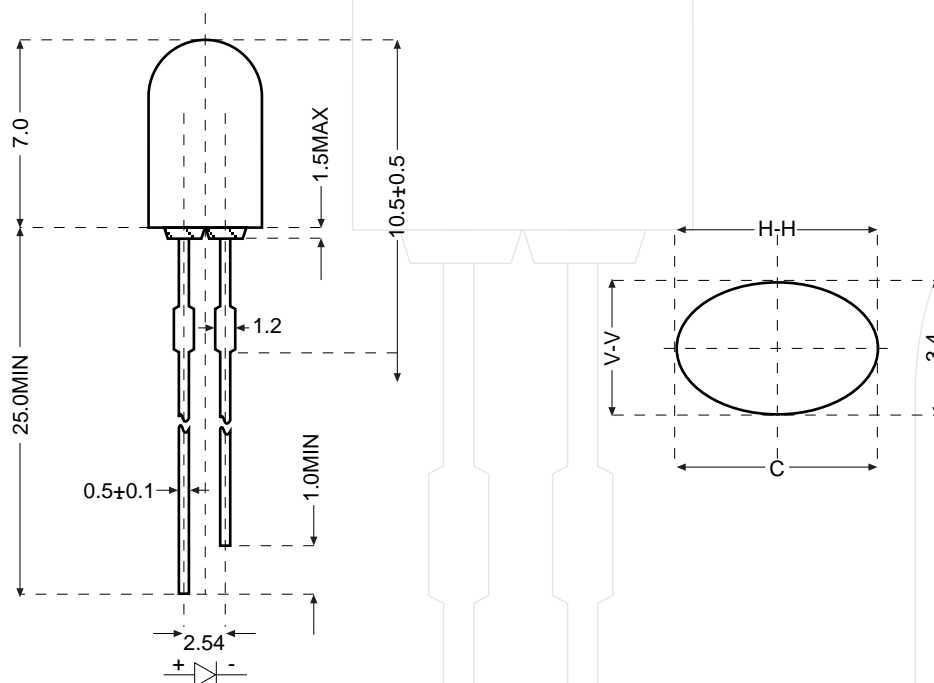

Oval LED Series

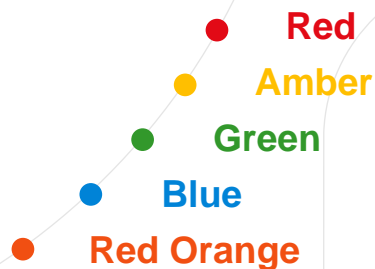

REFERENCE ONLY

Absolute Maximum Rating

Items	Symbol	Red	Blue / Green	Amber	Red Orange	Unit
Forward Current	I_F	50	25	50	50	mA
Peak Forward Current	I_{FP}	200	100	200	200	mA
Reverse Voltage	V_R	5	5	5	5	V
Power Dissipation	P_D	130	105	125	130	mW
Operating Temperature	T_{opr}	-40 to +95	-20 to +75	-40 to +95	-40 to +95	°C
Storage Temperature	T_{stg}	-40 to +100	-30 to +80	-40 to +100	-40 to +100	°C
Lead Soldering Temperature	T_{sol}	260	260	260	260	°C
		5 seconds	3 seconds	5 seconds	5 seconds	



Global Component Network LLC

5142 Clareton Dr, Unit 160, Agoura Hills, CA91301, USA

Tel: (818) 503 8204

Fax: (818) 301 2757

Website: www.gcndirect.com

Email: sales@gcndirect.com

LITEFO LTD.

Website: www.litefo.com

Email: sales@litefo.com



Oval LED Series

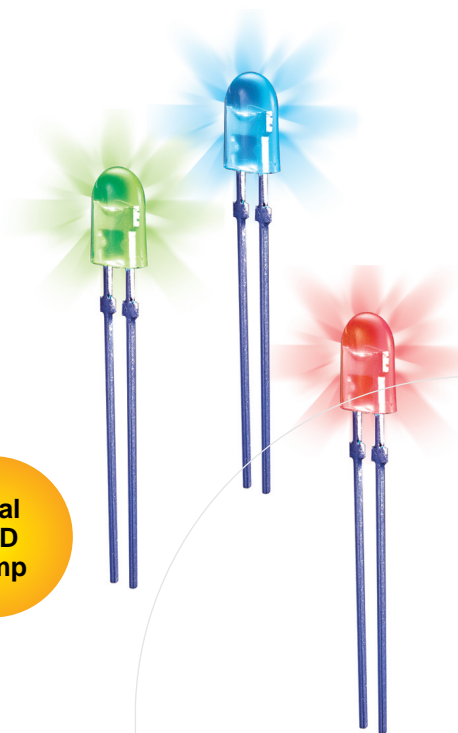
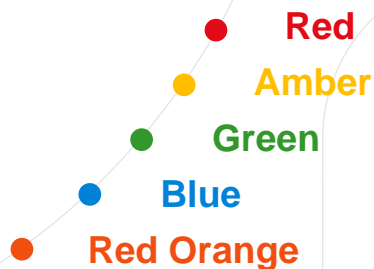

Oval LED Lamp

Features & Benefits

- Wide viewing angle suitable for large display areas
- Far field pattern optimum for large area full color screens
- RGB matched for color consistency
- Engineered to withstand a wide range of outdoor environmental conditions including exposure to a wide range of temperatures, high-humidity, and ultra-violet exposure

Applications

- Full Color Video Screens
- Single or Dual Color Graphic Signs
- Variable Message Signs (VMS)



Typical Electrical - Optical Characteristics at Ta 25°C, I_f = 20mA

Typical Electrical

Part No.	Size	Color	Viewing Angle	Luminous Intensity (mcd)		Dominant Wavelength(nm) Typ.	Forward Voltage (dc) (V)	
				Min.	Typ.		Typ.	Max.
FO5S0DTRO11	5	Red Orange	110	550	800	618	2.3	2.6
FO5B0DTYL11	5	Amber	110	390	600	591	2.3	2.6
FO5B0DPBL11	5	Blue	110	200	320	470	3.6	4.2
FO570DTHR11	5	Red	70	770	850	628	2.3	2.6
FO570DNYL11	5	Amber	70	390	550	591	2.0	2.5
FO570DNBL11	5	Blue	70	145	240	470	3.6	4.2
FO570DNPG11	5	Green	70	550	1000	525	3.6	4.2